



Sealed Air

Shrink Packaging Division

Equipment Center

100 Westford Road

Ayer MA 01432 Telephone: (978) 487-2288

Opti-Seal 4500

Catalogo ricambi

(Valido dalla matricola nr. 531 del 11.2002 per la macchina col.grigio RAL7040)

Spare parts catalogue

(Valid from serial number 531 dated 11.2002 for grey RAL7040 machine)

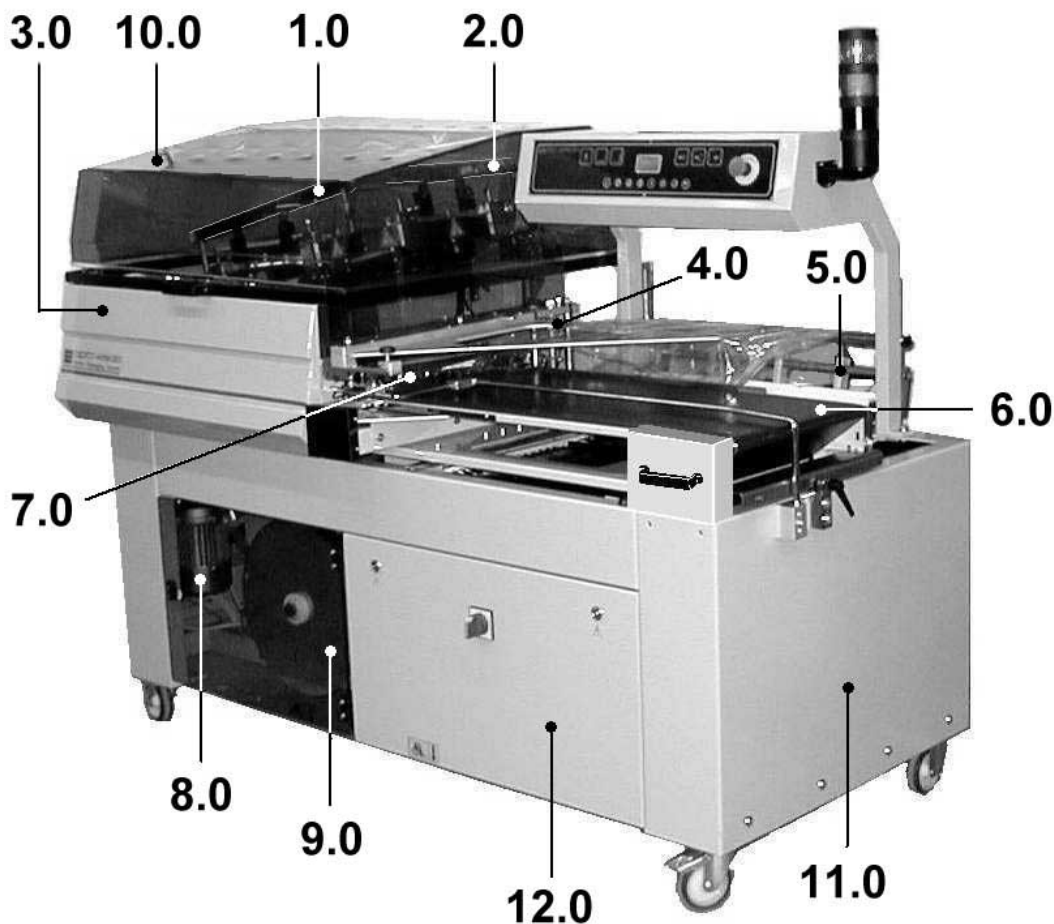

Consultare attentamente questo libretto prima di ordinare pezzi di ricambio
Carefully read this booklet before ordering spare parts



DOC. N. FM112048
REV. 01
Ed: 04.2003

УПАКОВОЧНОЕ ОБОРУДОВАНИЕ



ПРОИЗВОДСТВО И ПОСТАВКА
СЕРВИСНЫЙ РЕМОНТ
ЗАПАСНЫЕ ЧАСТИ
РАСХОДНЫЕ МАТЕРИАЛЫ

Диагностика, ремонт, сервисное обслуживание.

Запасные части и расходный материал: резина, тефлоновая лента, термонож (лезвие), гель для смазки.

Плѐнка термоусадочная полиолефиновая.

Система «Trade-In» – замена Вашего оборудования на новое и более производительное.



На фото: запайщик Magnetic FL900 + туннель Magnetic T100

ООО «АРДсистемы»

(495) 231-21-00

(812) 363-20-22

info@ardsystems.ru

www.filmtrade.ru

www.ardsystems.ru

| |
|---|
| INDICE DELLE TAVOLE TABLES INDEX |
|---|

| TAVOLA TABLE | DENOMINAZIONE DESCRIPTION |
|-------------------------|--|
| 1.0 | GRUPPO BARRA SALDANTE LUNGA LONG SEALING BAR GROUP |
| 2.0 | GRUPPO BARRA SALDANTE CORTA SHORT SEALING BAR GROUP |
| 3.0 | GRUPPO SOLLEVAMENTO BARRE SALDANTI SEALING BAR LIFTING GROUP |
| 4.0 | GRUPPO APRIFILM OPENING FILM GROUP |
| 5.0 | GRUPPO SVOLGITORE FILM UNWINDER FILM GROUP |
| 6.0 | GRUPPO NASTRO INGRESSO INLET CONVEYOR GROUP |
| 7.0 | GRUPPO NASTRO USCITA OUTLET CONVEYOR GROUP |
| 7.1 | GRUPPO NASTRO USCITA (versione con kit avvicinamento nastro) OUTLET CONVEYOR GROUP (for style with kissing belt device) |
| 8.0 | GRUPPO TRAINO FILM ENTRAINMENT FILM GROUP |
| 9.0 | GRUPPO AVVOLGITORE FILM FILM WINDER GROUP |
| 10.0 | GRUPPO CAMPANA SUPERIORE UPPER HOOD GROUP |
| 11.0 | GRUPPO CARENATURA BODYWORK GROUP |
| 12.0 | IMPIANTO ELETTRICO WIRING SYSTEM |
| 13.0 | IMPIANTO PNEUMATICO PNEUMATIC SYSTEM |
| 13.1 | IMPIANTO PNEUMATICO (versione con kit avvicinamento nastro) PNEUMATIC SYSTEM (for style with kissing belt device) |

**GRUPPO BARRA SALDANTE LUNGA
LONG SEALING BAR GROUP****1.0**

| POS. POS. | CODICE COD. | QUANTITA' QUANTITY | DENOMINAZIONE DESCRIPTION |
|----------------------|------------------------|-------------------------------|--|
| 1 | FE220107 | 2 | Microinterruttore Microswitch |
| 2 | FM200150 | 2 | Vite Screw |
| 3 | FM170108 | 2 | Molla Spring |
| 4 | FM040100 | 2 | Blocchetto Bracket |
| 5 | FM350043 | 2 | Rondella in gomma Rubber |
| 6 | KR210033 | 1 | Kit protezioni barra saldante lunga Long sealing bar fender kit |
| 7 | KR210009 | 1 | Kit teflon protezioni Teflon fender kit |
| 8 | FE435001 | 1 | Termocoppia Termocouple |
| 9 | FE380053 | 1 | Resistenza Heater |
| 10 | KR210007 | 1 | Kit barra saldante lunga Long sealing bar kit |
| 11 | FE385618 | 1 | Lama Blade |
| 11.1 | FE385619 | 1 | Lama 0,7mm x politene Blade 0,7mm for polythene |
| 12 | KR210002 | 1 | Kit gomma Rubber kit |
| 13 | FM282068 | 1 | Controbarra Contrast bar |
| 14 | FM170129 | 3 | Molla Spring |
| 15 | KR210001 | 1 | Kit teflon Teflon kit |

GRUPPO BARRA SALDANTE LUNGA
LONG SEALING BAR GROUP

1.0

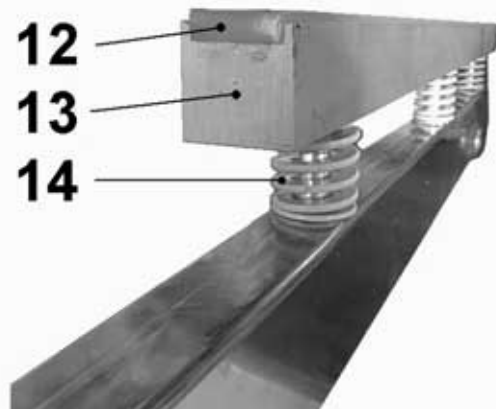
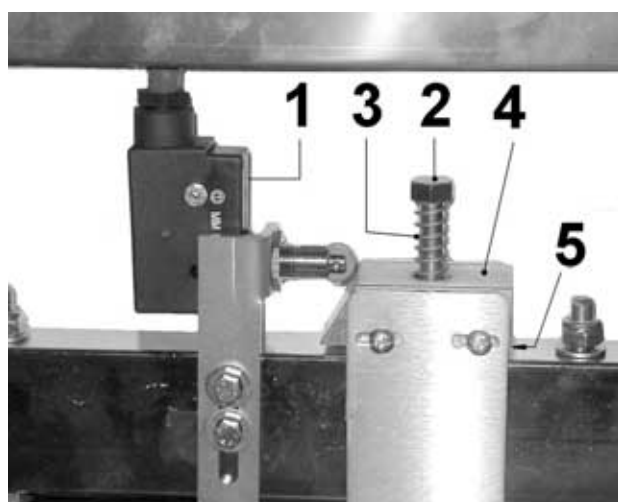
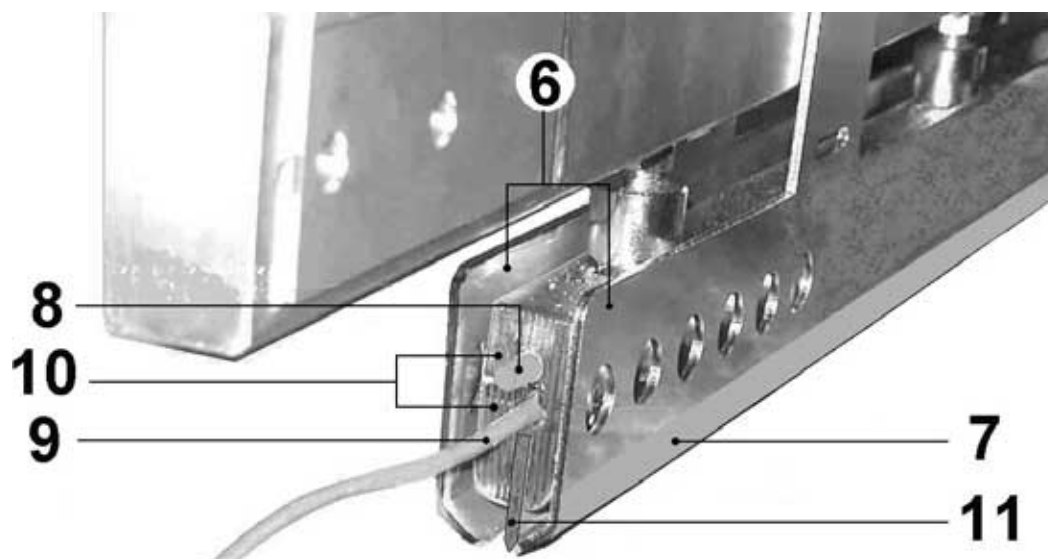

**GRUPPO BARRA SALDANTE CORTA
SHORT SEALING BAR GROUP****2.0**

| POS. POS. | CODICE COD. | QUANTITA' QUANTITY | DENOMINAZIONE DESCRIPTION |
|----------------------|------------------------|-------------------------------|---|
| 1 | FE220107 | 2 | Microinterruttore Microswitch |
| 2 | FM200150 | 2 | Vite Screw |
| 3 | FM170108 | 2 | Molla Spring |
| 4 | FM040100 | 2 | Blocchetto Bracket |
| 5 | FM350043 | 2 | Rondella in gomma Rubber |
| 6 | KR210034 | 1 | Kit protezioni barra saldante corta Short sealing bar fender kit |
| 7 | KR210009 | 1 | Kit teflon protezioni Teflon fender kit |
| 8 | FE435002 | 1 | Termocoppia Termocouple |
| 9 | FE380054 | 1 | Resistenza Heater |
| 10 | KR210008 | 1 | Kit barra saldante corta Short sealing bar kit |
| 11 | FE385618 | 1 | Lama Blade |
| 11.1 | FE385619 | 1 | Lama 0,7mm x politene Blade 0,7mm for polythene |
| 12 | KR210002 | 1 | Kit gomma Rubber kit |
| 13 | FM282068 | 1 | Controbarra Contrast bar |
| 14 | FM170129 | 3 | Molla Spring |
| 15 | KR210001 | 1 | Kit teflon Teflon kit |

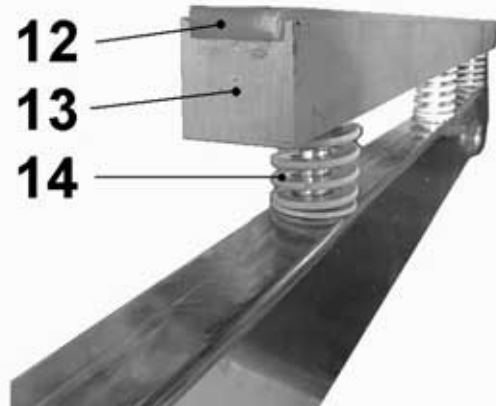
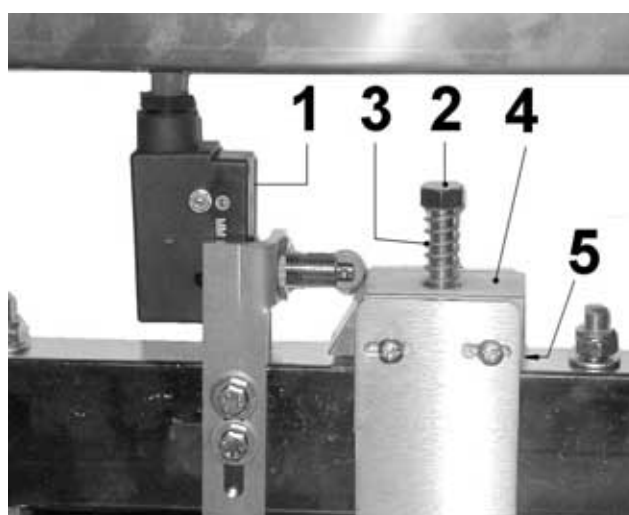
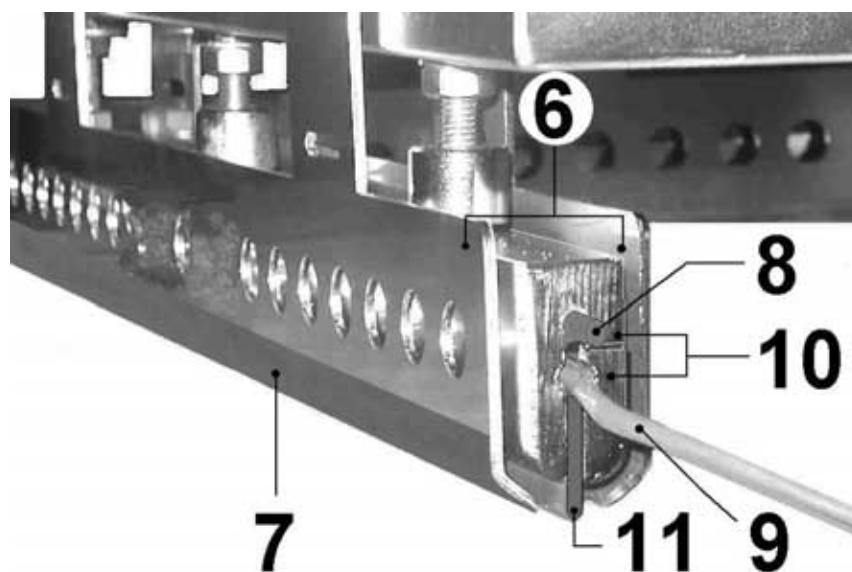

**GRUPPO SOLLEVAMENTO BARRE SALDANTI
SEALING BAR LIFTING GROUP**

3.0

| POS. POS. | CODICE COD. | QUANTITA' QUANTITY | DENOMINAZIONE DESCRIPTION |
|----------------------|------------------------|-------------------------------|--|
| 1 | FM580061 | 1 | Cilindro Cylinder |
| 2 | FM580103 | 1 | Sensore per cilindro Sensor for cylinder |
| 3 | FM580104 | 1 | Staffa per cilindro Cylinder bracket |
| 4 | FM060002 | 2 | Leva attacco barra Coupling bar lever |
| 5 | FM120003 | 3 | Flangia Flange |
| 6 | FM610716 | 2 | Supporto Support |
| 7 | FM060003 | 1 | Leva attacco cilindro Coupling cylinder lever |
| 8 | FE220156 | 1 | Sensore induttivo Inductive sensor |
| 9 | FM282086 | 1 | Squadretta Square |

GRUPPO SOLLEVAMENTO BARRE SALDANTI
SEALING BAR LIFTING GROUP

3.0

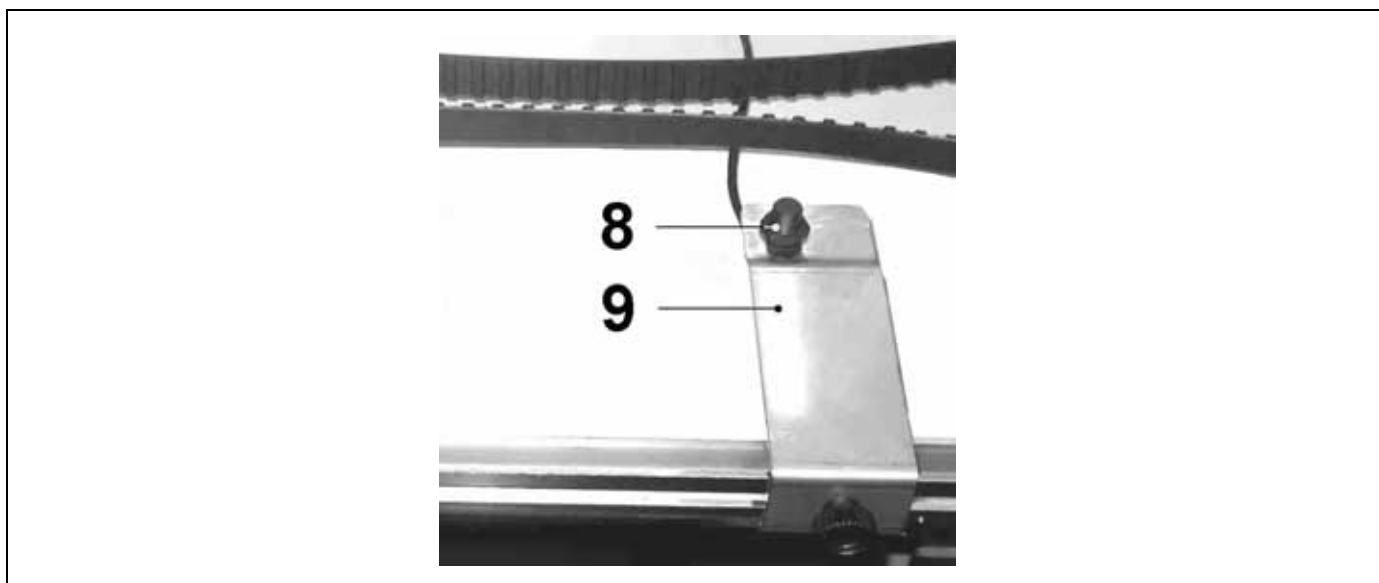
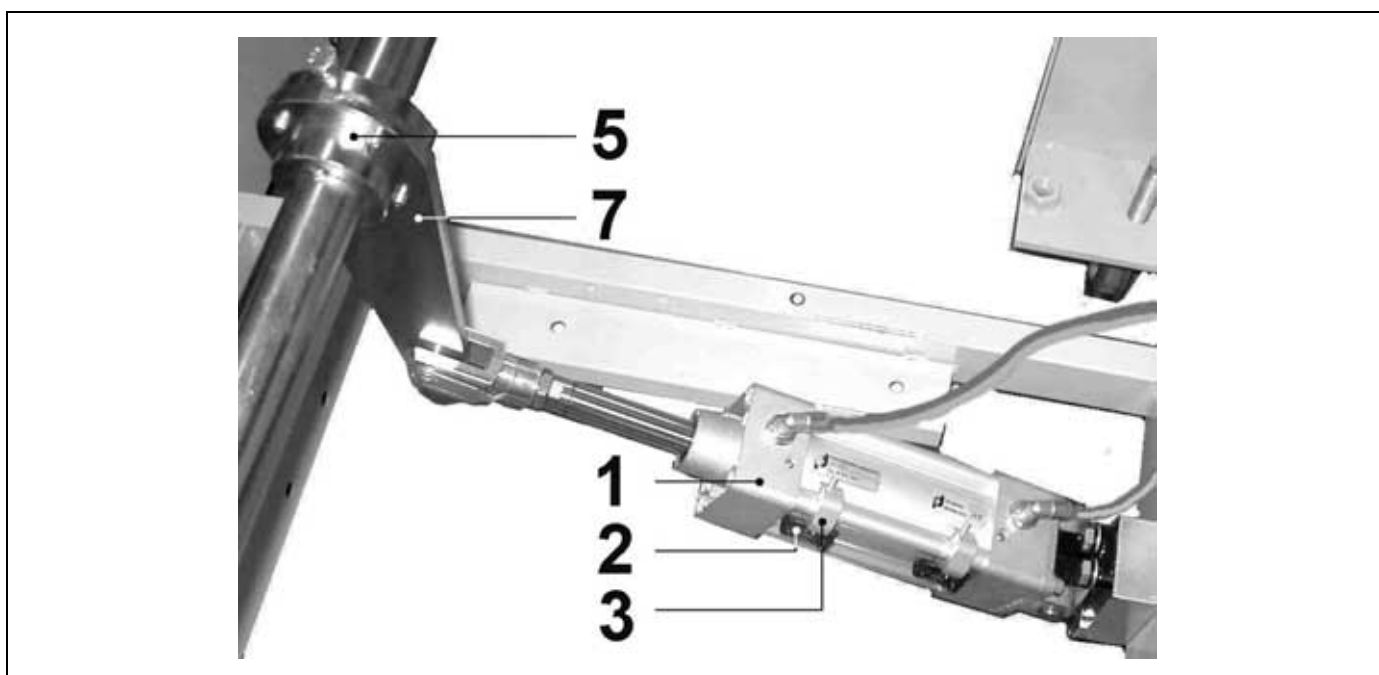
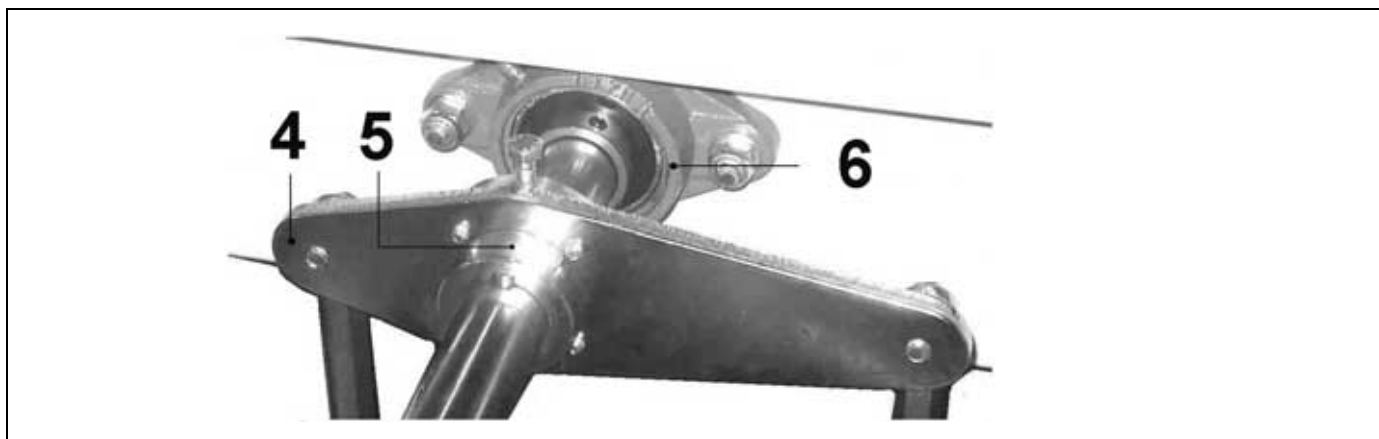

**GRUPPO APRIFILM
OPENING FILM GROUP**

4.0

| POS. POS. | CODICE COD. | QUANTITA' QUANTITY | DENOMINAZIONE DESCRIPTION |
|----------------------|------------------------|-------------------------------|---|
| 1 | FM282075 | 2 | Triangolo aprifilm Opening film triangle |
| 2 | FM030116 | 1 | Asta guida prodotto Product guide rod |
| 3 | FM030115 | 1 | Asta di appoggio Bearing rod |
| 4 | FM030104 | 1 | Asta aprifilm Opening film rod |
| 5 | FM510075 | 2 | Volantino M6X16 Handwheel M6X16 |
| 6 | FM160264 | 2 | Distanziale Spacer |
| 7 | FM260072 | 1 | Ruota dentata orizzontale Horizontal spur gear |
| 8 | FM260071 | 1 | Ruota dentata verticale Vertical spur gear |
| 9 | FE220105 | 2 | Microinterruttore Microswitch |
| 10 | FM260082 | 1 | Puleggia motorizzata Motorized pulley |
| 10.1 | FM260081 | 1 | Puleggia condotta Driven pulley |
| 11 | FM530002 | 1 | Cinghia dentata 124 L050 Belt 124 L050 |
| 12 | FE250056 | 1 | Motoriduttore Gearmotor |
| 13 | FE220156 | 1 | Sensore induttivo Inductive sensor |

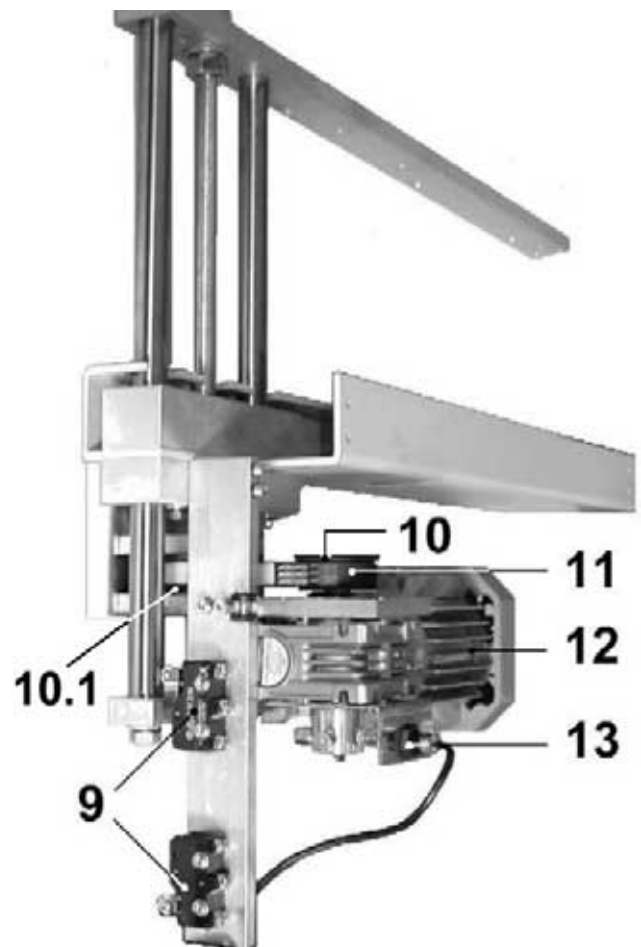
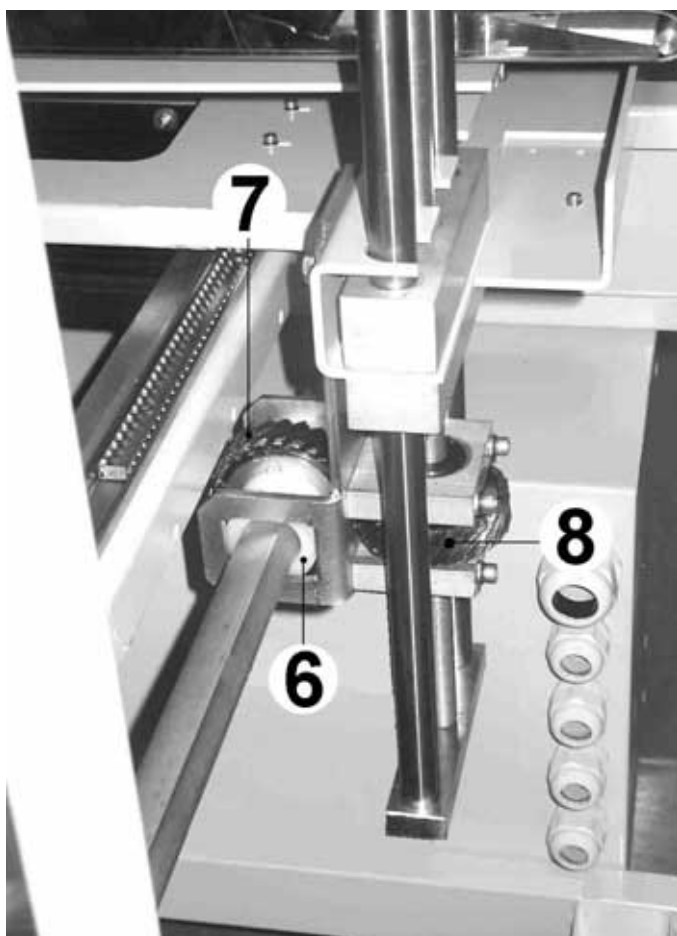
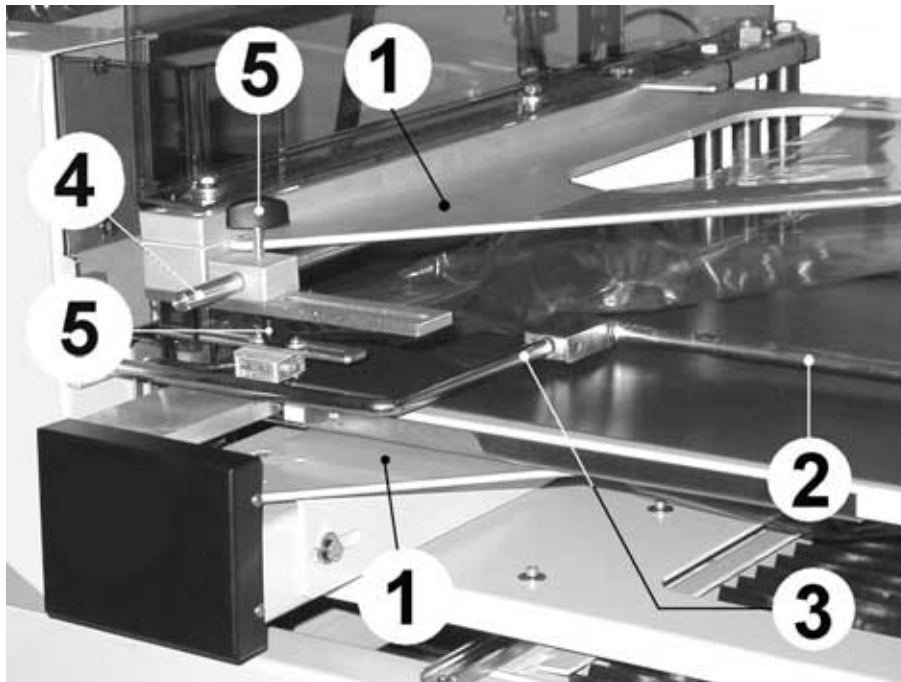

- ❑ Valido fino alla matricola nr. 530 del 11.2002 per la macchina color grigio RAL7040.
- ❑ Valid at to serial number 530 dated 11.2002 for grey RAL7040 machine.

- ❑ Valido dalla matricola nr. 531 del 11.2002 per la macchina color grigio RAL7040.
- ❑ Valid from serial number 531 dated 11.2002 for grey RAL7040 machine.

**GRUPPO SVOLGITORE FILM
UNWINDER FILM GROUP****5.0**

| POS. POS. | CODICE COD. | QUANTITA' QUANTITY | DENOMINAZIONE DESCRIPTION |
|----------------------|------------------------|-------------------------------|--|
| 1 | FE250055 | 1 | Motoriduttore Geared motor |
| 2 | FM610703 | 3 | Supporto Support |
| 3 | KR210010 | 1 | Kit guida dx posizionamento bobina Right slide kit for roll positioning |
| 4 | KR210011 | 1 | Kit guida sx posizionamento bobina Left slide kit for roll positioning |
| 5 | KR210012 | 1 | Kit rullo motore Motor roller kit |
| 6 | KR210013 | 1 | Kit rullo condotto Driven roller kit |
| 7 | KR210014 | 1 | Kit rullo rinvio fisso Fixed transmission roller kit |
| 8 | KR210015 | 1 | Kit rullo rinvio flottante Floating transmission roller kit |
| 9 | FE220107 | 1 | Microinterruttore Microswitch |
| 10 | KR210005 | 3 | Kit rotellina con aghi + leva Needles wheels + lever kit |
| 11 | FM350600 | 1 | Spazzola per microforatori Microperforators brush |
| 12 | FM220537 | 2 | Angolare Corner |
| 13 | FM290375 | 1 | Supporto microforatore Microperforator support |
| 13.1 | FM282131 | 1 | Piastra dx microforatore Microperforator right plate |
| 13.2 | FM282132 | 1 | Piastra sx microforatore Microperforator left plate |
| 14 | FM510020 | 2 | Volantino M6X30 Handwheel M6X30 |
| 14.1 | FM510075 | 1 | Volantino M6X16 Handwheel M6X16 |
| 15 | FM030101 | 1 | Asta guida film Film slide rod |
| 16 | KR210006 | 1 | Kit microforatore Microperforator kit |

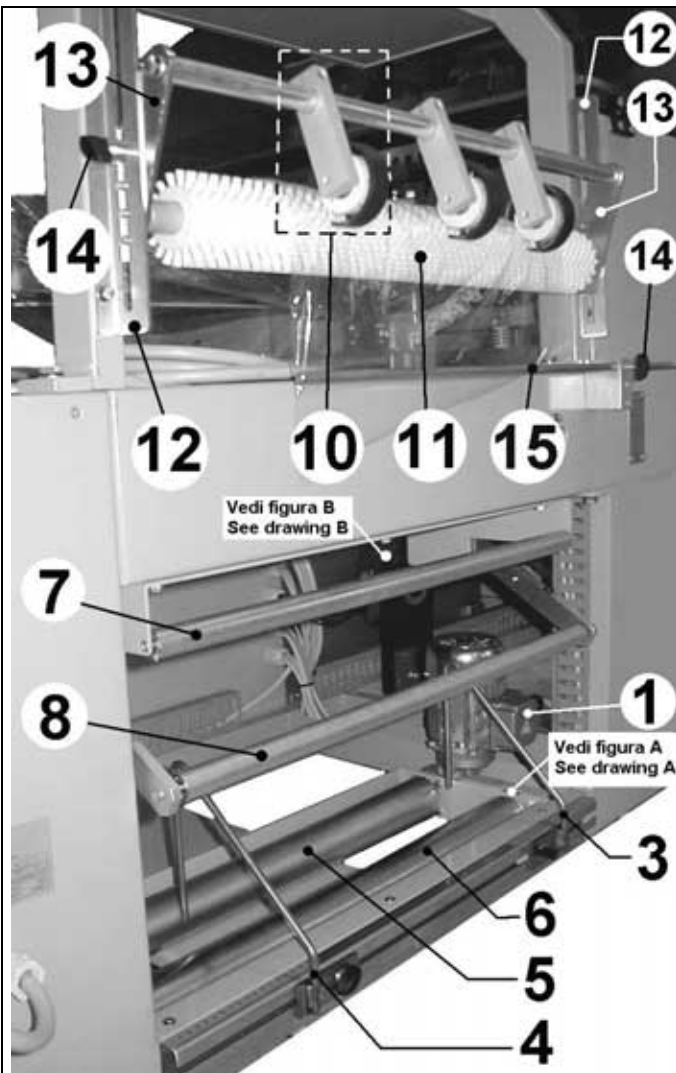

- ❑ Valido fino alla matricola nr. 530 del 11.2002 per la macchina color grigio RAL7040.
- ❑ Valid at to serial number 530 dated 11.2002 for grey RAL7040 machine.

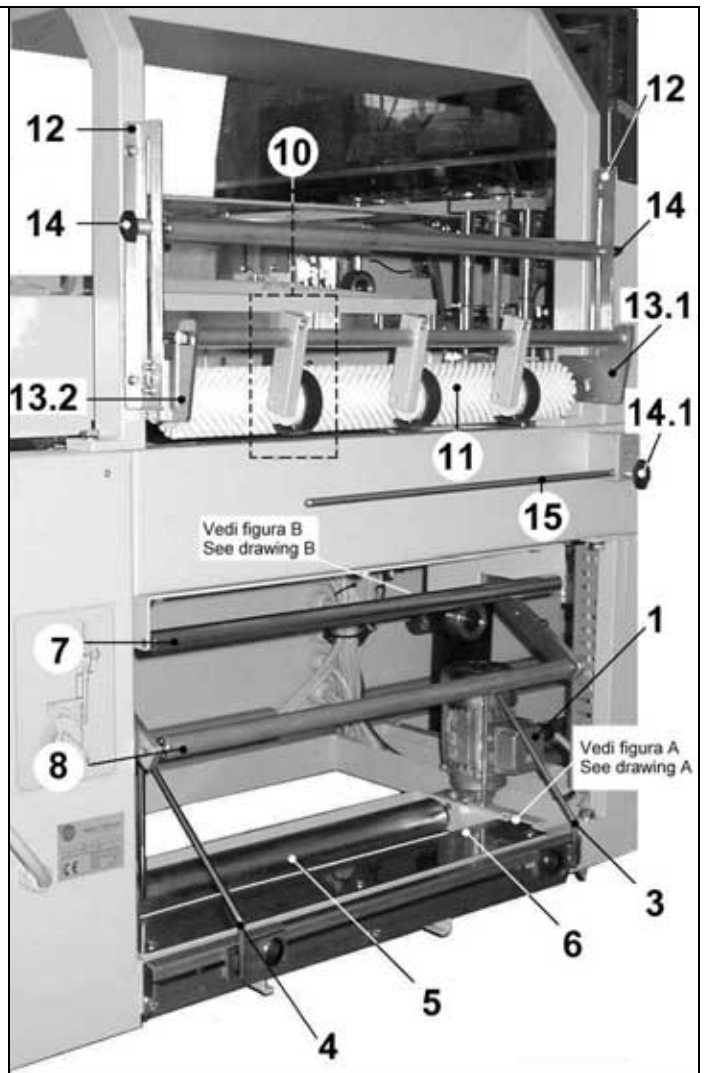

- ❑ Valido dalla matricola nr. 531 del 11.2002 per la macchina color grigio RAL7040.
- ❑ Valid from serial number 531 dated 11.2002 for grey RAL7040 machine.

Figura A / Drawing A



Figura B / Drawing B



**GRUPPO NASTRO INGRESSO
INLET CONVEYOR GROUP****6.0**

| POS. POS. | CODICE COD. | QUANTITA' QUANTITY | DENOMINAZIONE DESCRIPTION |
|----------------------|------------------------|-------------------------------|---|
| 1 | FE250058 | 1 | Motoriduttore completo Geared motor |
| 2 | FE240092 | 1 | Motore Motor |
| 3 | FM760020 | 1 | Riduttore Reduction gear |
| 4 | FE250054 | 1 | Braccio di reazione Torque arm |
| 5 | FM610715 | 2 | Supporto Support |
| 6 | FM250251 | 1 | Rullo rinvio Transmission roller |
| 7 | FM250252 | 1 | Rullo rinvio Transmission roller |
| 8 | FM250250 | 1 | Rullo gommato Rubber-coated roller |
| 9 | FM710122 | 1 | Nastro trasportatore Transport belt |
| 10 | FM282058 | 1 | Piatto supporto rullo Roll support plate |
| 11 | FM282056 | 1 | Squadretta Square |
| 12 | FM010150 | 1 | Albero rinvio Transmission shaft |
| 13 | FE220157 | 2 | Fotocellula Photocell |
| 14 | FE220158 | 2 | Fotocellula Photocell |

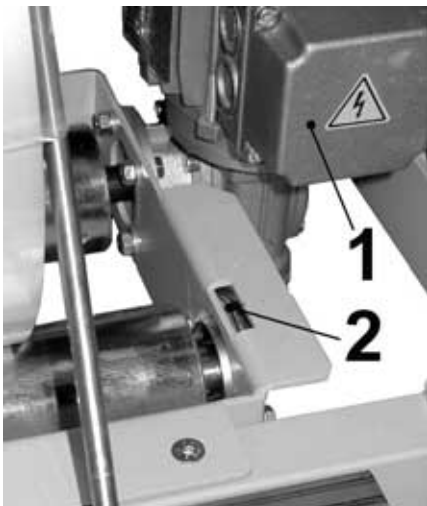
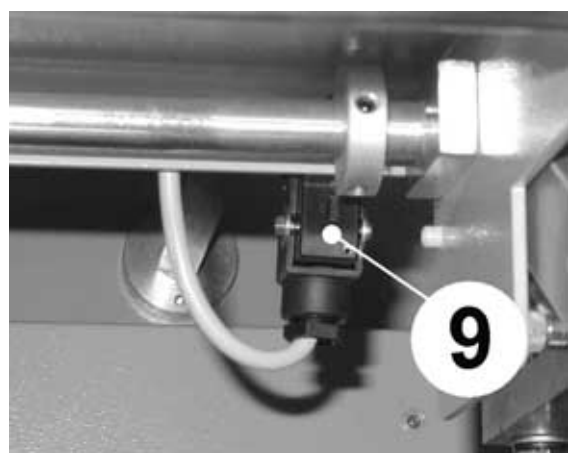
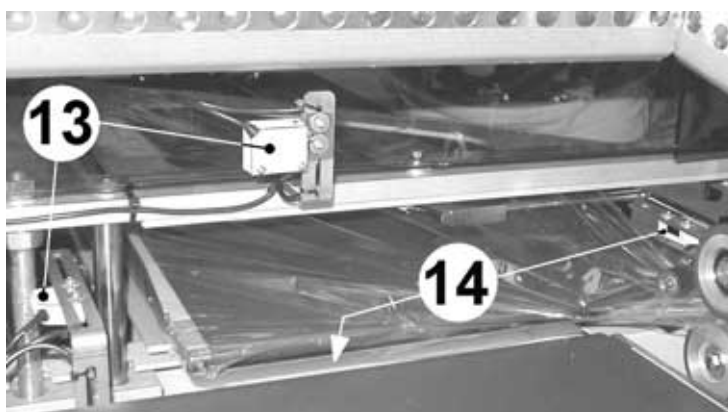
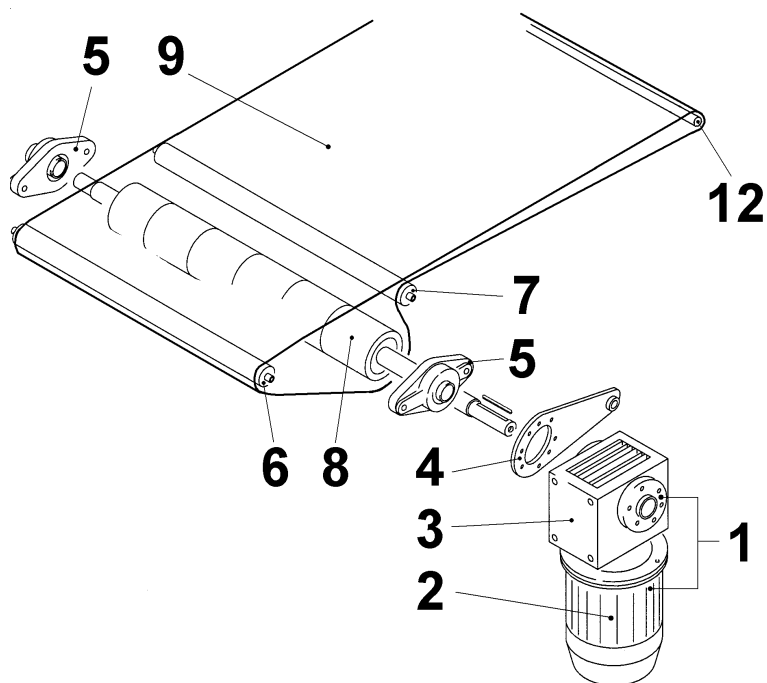
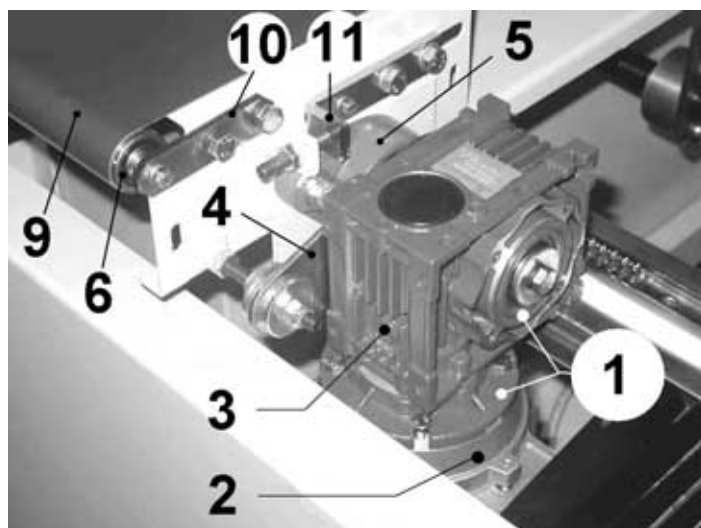

**GRUPPO NASTRO USCITA
OUTLET CONVEYOR GROUP**

7.0

| POS. POS. | CODICE COD. | QUANTITA' QUANTITY | DENOMINAZIONE DESCRIPTION |
|----------------------|------------------------|-------------------------------|---|
| 1 | FE250053 | 1 | Motoriduttore completo Geared motor |
| 2 | FE240090 | 1 | Motore Motor |
| 3 | FM760020 | 1 | Riduttore Reduction gear |
| 4 | FE250054 | 1 | Braccio di reazione Torque arm |
| 5 | FM610715 | 2 | Supporto Support |
| 6 | FM250251 | 2 | Rullo rinvio Transmission roller |
| 7 | FM250252 | 2 | Rullo rinvio Transmission roller |
| 8 | FM250250 | 1 | Rullo gommato Rubber-coated roller |
| 9 | KR210016 | 1 | Nastro con giunzione Junction conveyor |
| 10 | FM282059 | 2 | Squadretta Square |

**GRUPPO NASTRO USCITA
OUTLET CONVEYOR GROUP**

7.0

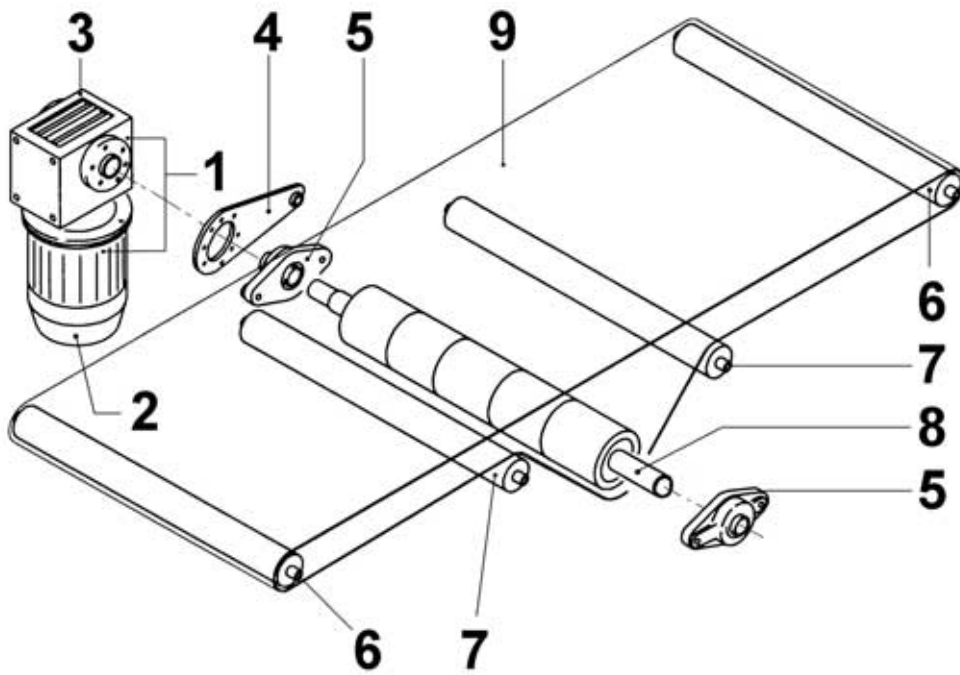
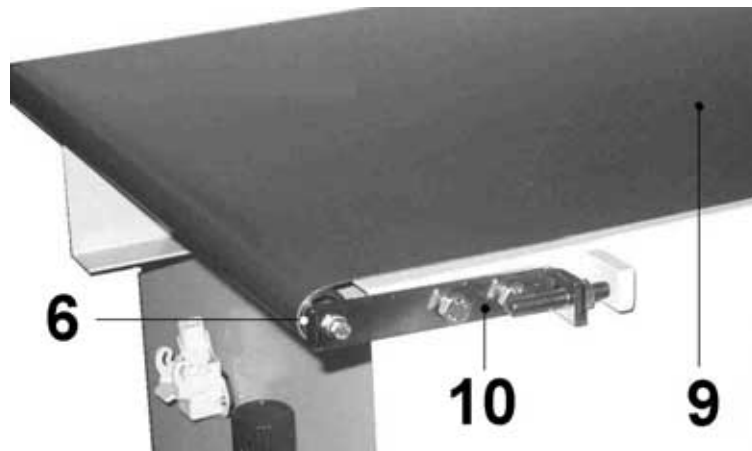

**GRUPPO NASTRO USCITA (versione con kit avvicinamento nastro)
OUTLET CONVEYOR GROUP (for style with kissing belt device)**

7.1

| POS. POS. | CODICE COD. | QUANTITA' QUANTITY | DENOMINAZIONE DESCRIPTION |
|----------------------|------------------------|-------------------------------|---|
| 1 | FE250053 | 1 | Motoriduttore completo Geared motor |
| 2 | FE240090 | 1 | Motore Motor |
| 3 | FM760020 | 1 | Riduttore Reduction gear |
| 4 | FE250054 | 1 | Braccio di reazione Torque arm |
| 5 | FM610715 | 2 | Supporto Support |
| 6 | FM250251 | 2 | Rullo rinvio Transmission roller |
| 7 | FM250252 | 4 | Rullo rinvio Transmission roller |
| 8 | FM250250 | 1 | Rullo gommato Rubber-coated roller |
| 9 | KR210028 | 1 | Nastro con giunzione Junction conveyor |
| 10 | FM282059 | 2 | Squadretta Square |
| 11 | FM580062 | 1 | Cilindro Cylinder |
| 12 | KR210027 | 4 | Kit manicotto per asta spintore Coupling sleeve for pusher rod |
| 13 | FM030100 | 2 | Asta spintore Pusher rod |

GRUPPO NASTRO USCITA (versione con kit avvicinamento nastro)
OUTLET CONVEYOR GROUP (for style with kissing belt device)

7.1



Figura A / Drawing A



**GRUPPO TRAINO FILM
ENTRAINMENT FILM GROUP**

8.0

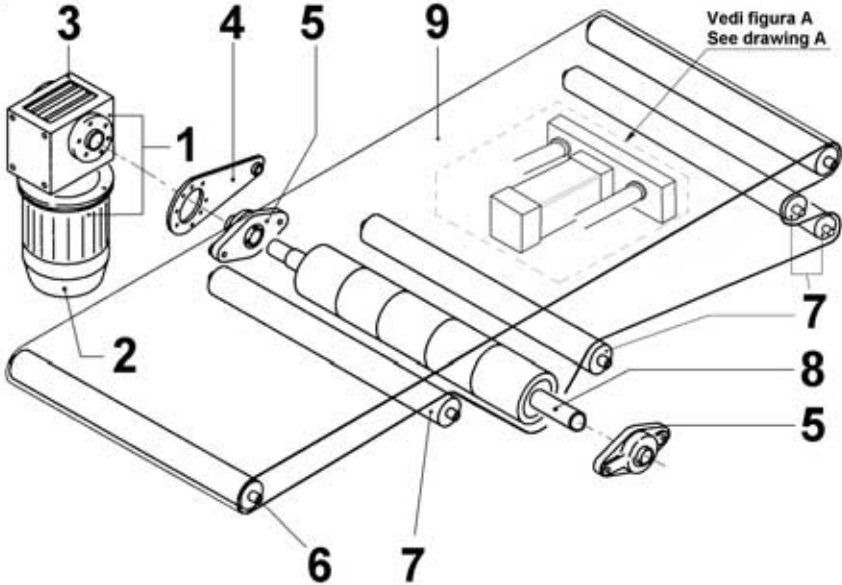
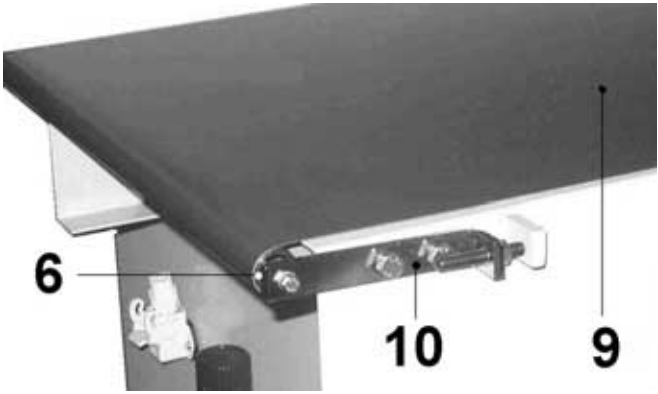
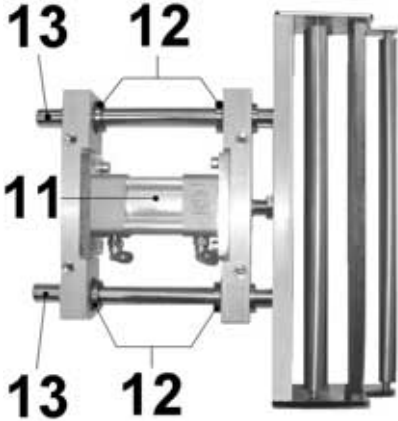
| POS. POS. | CODICE COD. | QUANTITA' QUANTITY | DENOMINAZIONE DESCRIPTION |
|----------------------|------------------------|-------------------------------|--|
| 1 | FM530023 | 1 | Cinghia 540 H075 Belt 540 H075 |
| 2 | FM530022 | 1 | Cinghia 300 H075 Belt 300 H075 |
| 3 | FM250257 | 2 | Rullino rinvio film Film transmission roller |
| 4 | FM610717 | 2 | Supporto Support |
| 5 | FM260074 | 1 | Puleggia PD19H075 Pulley PD19H075 |
| 5.1 | FM260076 | 1 | Puleggia PD19H075 Pulley PD19H075 |
| 6 | FM260073 | 2 | Puleggia PD15H075 Pulley PD15H075 |
| 7 | KR210017 | 1 | Kit rotelle tendifilm Wheels tightener kit |
| 8 | KR210018 | 1 | Kit rotella condotta trascinatore Entrainer control wheel kit |
| 9 | KR210019 | 1 | Kit rotella motrice trascinatore Entrainer tractor wheel kit |
| 10 | FM170157 | 1 | Molla Spring |
| 11 | KR210023 | 1 | Kit squadretta passafilm Fairlead square kit |
| 12 | FE220156 | 1 | Sensore induttivo Inductive sensor |
| 13 | KR210030 | 1 | Kit rullo rinvio film mobile Valido dalla matricola nr. 586 del 05.2003 per la macchina color grigio RAL7040. Mobile film tension roller kit Valid from serial number 586 dated 05.2003 for grey RAL7040 machine. |

**GRUPPO AVVOLGITORE FILM
FILM WINDER GROUP****9.0**

| POS. POS. | CODICE COD. | QUANTITA' QUANTITY | DENOMINAZIONE DESCRIPTION |
|----------------------|------------------------|-------------------------------|---|
| 1 | KR210035 | 1 | Kit avvolgitore inferiore Lower winder kit |
| 2 | FM040101 | 1 | Blocchetto Block |
| 3 | FM610070 | 2 | Cuscinetto Bearing |
| 4 | FM290387 | 1 | Supporto Support |
| 5 | FM160258 | 1 | Anello di contenimento Containing ring |
| 6 | FM610055 | 1 | Ruota libera Free wheel |
| 7 | FM260069 | 1 | Puleggia Pulley |
| 8 | FM160299 | 1 | Anello di contenimento Containing ring |
| 9 | FM010155 | 1 | Albero Shaft |
| 10 | FM120028 | 1 | Flangia posteriore Rear flange |
| 11 | FM120033 | 1 | Flangia anteriore Front flange |
| 12 | FM250271 | 1 | Mozzo Hub |
| 13 | FM160260 | 1 | Ghiera Ring nut |
| 14 | FM170141 | 1 | Molla Spring |
| 15 | FM510071 | 1 | Volantino Handwheel |
| 16 | FM530007 | 1 | Cinghia 480 L050 Belt 480 L050 |
| 17 | FE250053 | 1 | Motoriduttore completo Geared motor |
| 18 | FE240090 | 1 | Motore Motor |
| 19 | FM760020 | 1 | Riduttore Reduction gear |
| 20 | FM260075 | 1 | Puleggia Pulley |

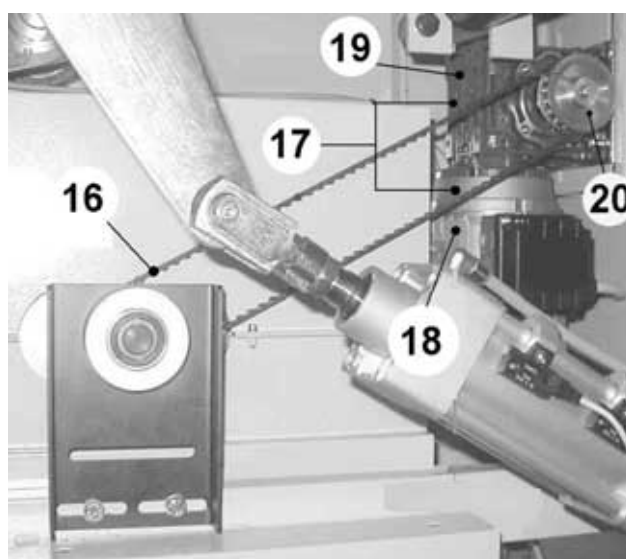
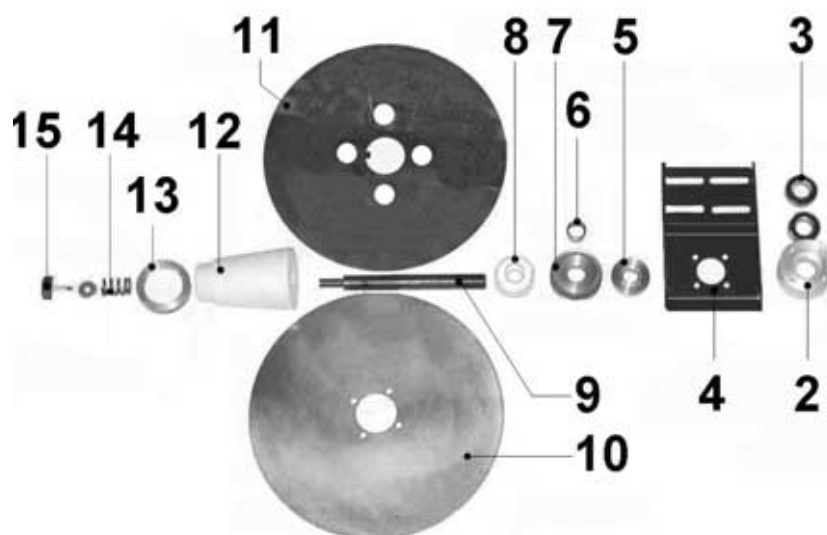

**GRUPPO CAMPANA SUPERIORE
UPPER HOOD GROUP**

10.0

| POS. POS. | CODICE COD. | QUANTITA' QUANTITY | DENOMINAZIONE DESCRIPTION |
|----------------------|------------------------|-------------------------------|---|
| 1 | FM080040 | 1 | Campana superiore Upper hood |
| 2 | KR210024 | 1 | Kit profilati fermavetro Lock channels kit |
| 3 | KR210025 | 1 | Kit maniglia campana superiore Upper hood handle kit |
| 4 | KR210026 | 3 | Kit cerniera campana superiore Upper hood hinge kit |
| 5 | FM640021 | 1 | Estensore Shock absorber |
| 6 | KR210036 | 1 | Kit microinterruttore Microswitch kit |

**GRUPPO CAMPANA SUPERIORE
UPPER HOOD GROUP**

10.0



Figura A / Drawing A



**GRUPPO CARENATURA
BODYWORK GROUP**

11.0

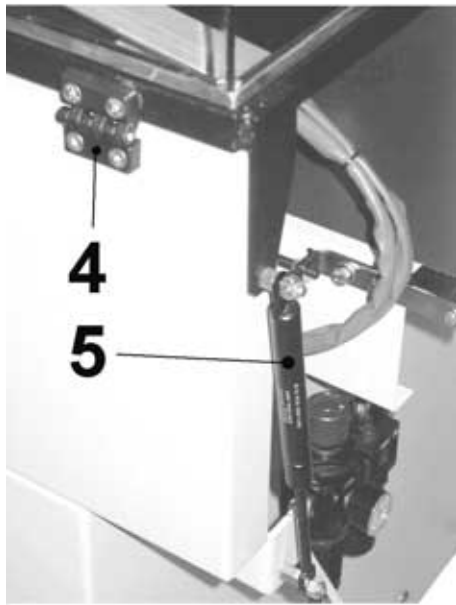
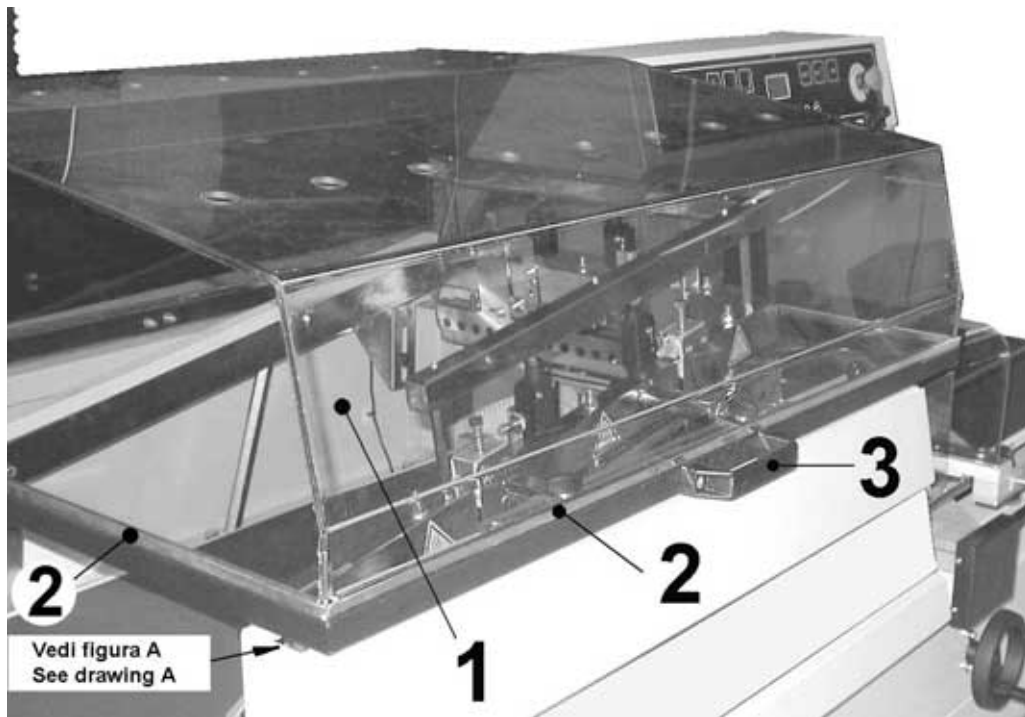
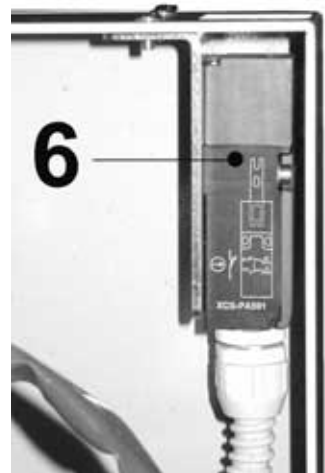
| POS. POS. | CODICE COD. | QUANTITA' QUANTITY | DENOMINAZIONE DESCRIPTION |
|----------------------|------------------------|-------------------------------|--------------------------------------|
| 1 | FM770501 | 2 | Ruota con freno Wheel with brake |
| 2 | FM770500 | 2 | Ruota Wheel |
| 3 | FM510049 | 2 | Volantino Handwheel |

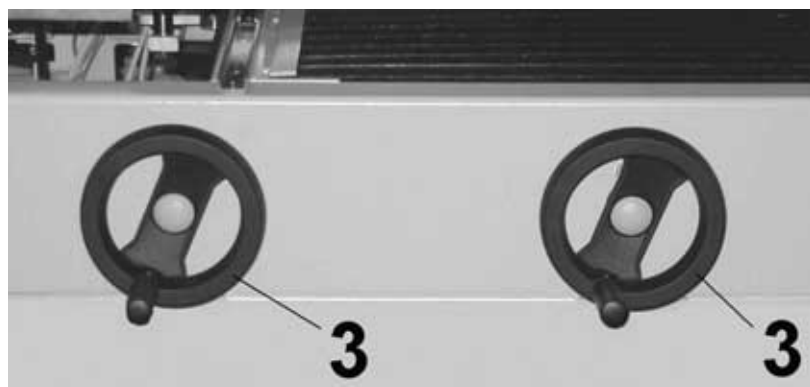

- Valido fino alla matricola nr. 530 del 11.2002 per la macchina color grigio RAL7040.
- Valid at to serial number 530 dated 11.2002 for grey RAL7040 machine.

**IMPIANTO ELETTRICO
WIRING SYSTEM****12.0**

| POS. POS. | CODICE COD. | QUANTITA' QUANTITY | DENOMINAZIONE DESCRIPTION |
|----------------------|------------------------|-------------------------------|---|
| 1 | KR210037 | 1 | Inverter Inverter |
| 2 | FE120354 | 2 | Modulo IN/OUT IN/OUT power board |
| 3 | FE120100 | 1 | Scheda alimentatore Infeed card |
| 4 | FE110602 | 7 | Contattore LC1-D09B7 Contactor LC1-D09B7 |
| 5 | FE440015 | 1 | Trasformatore 75VA V200-220-240/24 Transformer 75VA V200-220-240/24 |
| 5.1 | FE440016 | 1 | Trasformatore 75VA V380-415/24 Transformer 75VA V380-415/24 |
| 6 | FE080031 | 1 | Interruttore tripolare Three-pole switch |
| 7 | FE290121 | 2 | Fusibile T 2A Fuse T 2A |
| 8 | FE290402 | 4 | Fusibile 4A Fuse 4A |
| 9 | FE290405 | 2 | Fusibile 10A Fuse 10A |
| 10 | FE290410 | 2 | Fusibile 0,5A Fuse 0,5A |
| 11 | FE190007 | 1 | Relé termico 1,6-2,5A Thermal Relay 1,6-2,5A |
| 12 | FE190006 | 1 | Relé termico 1-1,7A Thermal Relay 1-1,7A |
| 13 | FE080032 | 1 | Contatto polo neutro Neutral contact pol |
| 14.1 | S0190069 | 1 | Pannello + scheda elettronica (x MF21BH21 / MF21BH22) Panel + electronic board (x MF21BH21 / MF21BH22) |
| 14.1.1 | S0190084 | 1 | Pannello + scheda elettronica (x MF21BB21) Panel + electronic board (x MF21BB21) |
| 14.2 | FM110194 | 1 | Membrana adesiva Panel adhesive label |
| 14.3 | FE120366 | 1 | Scheda di comando (x MF21BH21 / MF21BH22) Control card (x MF21BH21 / MF21BH22) |
| 14.3 | FE120370 | 1 | Scheda di comando (x MF21BB21) Control card (x MF21BB21) |
| 14.4 | SM190020 | 1 | Pannello di comando Control panel |
| 15 | FE340005 | 1 | Pulsante d'emergenza Emergency push-button |

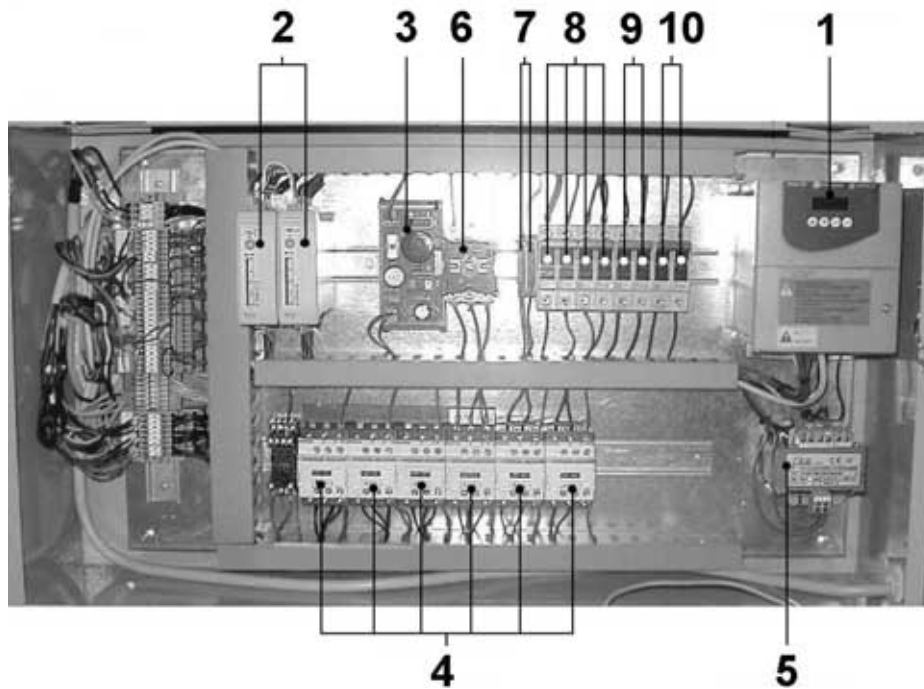

- Valido fino alla matricola nr. 530 del 11.2002 per la macchina color grigio RAL7040.
- Valid at to serial number 530 dated 11.2002 for grey RAL7040 machine.

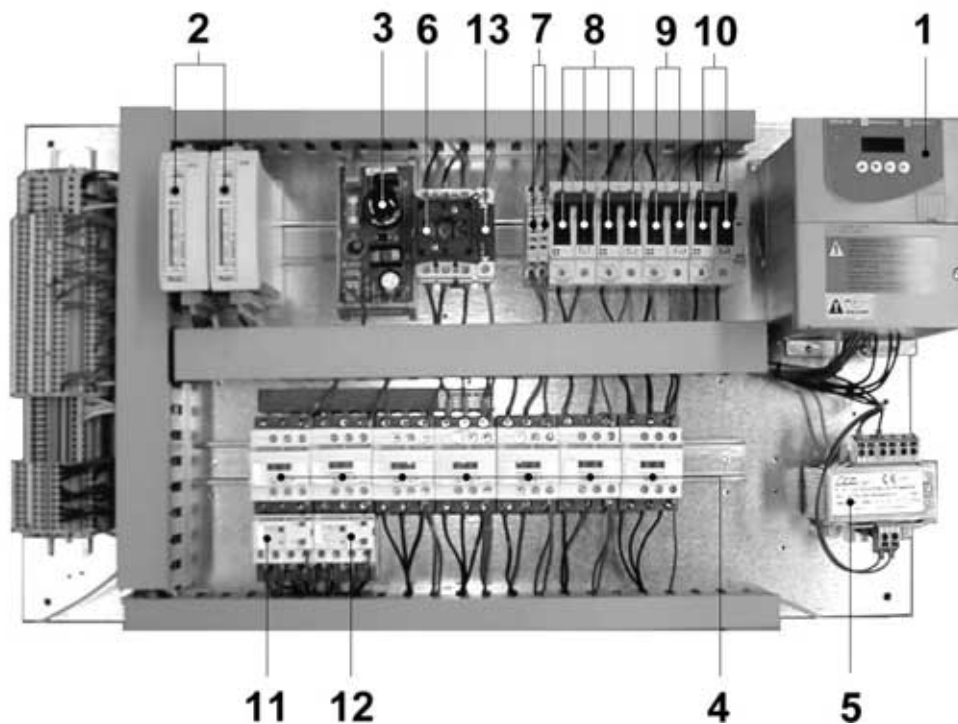

- Valido dalla matricola nr. 531 del 11.2002 per la macchina color grigio RAL7040.
- Valid from serial number 531 dated 11.2002 for grey RAL7040 machine.

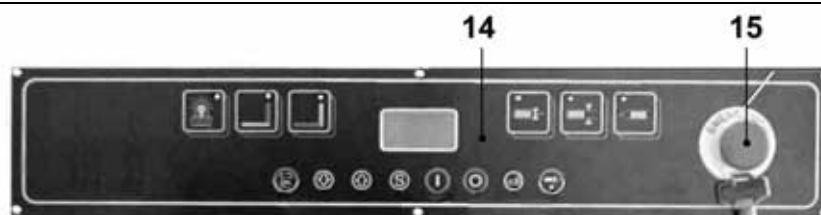

**IMPIANTO PNEUMATICO
PNEUMATIC SYSTEM****13.0**

| POS. POS. | CODICE COD. | QUANTITA' QUANTITY | DENOMINAZIONE DESCRIPTION |
|----------------------|------------------------|-------------------------------|---|
| 1 | FE140026 | 1 | Elettrovalvola Valve |
| 2 | FM720103 | 2 | Regolatore di scarico Exhaust regulators |
| 3 | FE140032 | 2 | Bobina Coil |
| 4 | FE090001 | 2 | Connettore Connector |
| 6 | FM720203 | 1 | Manometro Manometer |
| 7 | FM720215 | 1 | Gruppo FR+L FR+L Unit |

**IMPIANTO PNEUMATICO (versione con kit avvicinamento nastro)
PNEUMATIC SYSTEM (for style with kissing belt device)****13.1**

| POS. POS. | CODICE COD. | QUANTITA' QUANTITY | DENOMINAZIONE DESCRIPTION |
|----------------------|------------------------|-------------------------------|---|
| 1 | FE140026 | 1 | Elettrovalvola Valve |
| 2 | FE140027 | 1 | Elettrovalvola Valve |
| 3 | FE140032 | 3 | Bobina Coil |
| 4 | FE090001 | 3 | Connettore Connector |
| 5 | FM720103 | 4 | Regolatore di scarico Exhaust regulators |
| 6 | FM720203 | 1 | Manometro Manometer |
| 7 | FM720215 | 1 | Gruppo FR+L FR+L Unit |

**IMPIANTO PNEUMATICO
PNEUMATIC SYSTEM**

13.0

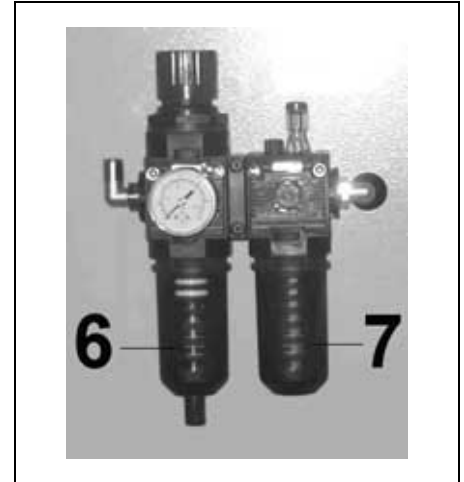
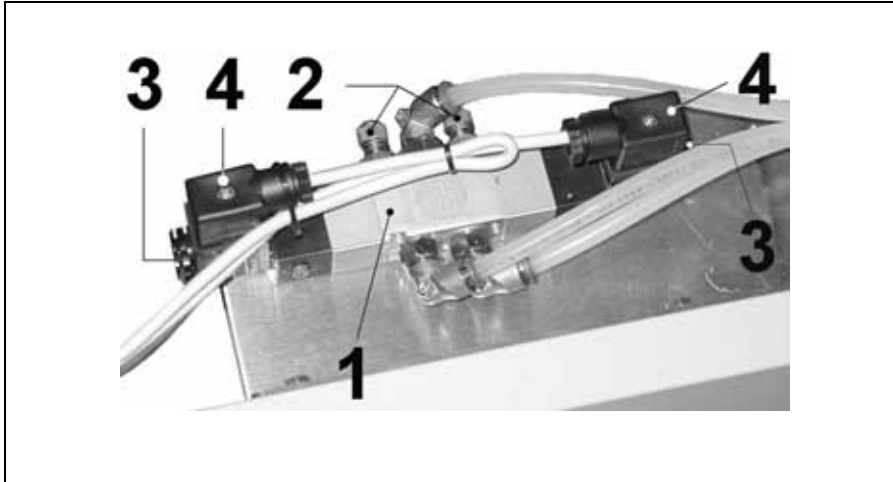

**IMPIANTO PNEUMATICO (versione con kit avvicinamento nastro)
PNEUMATIC SYSTEM (for style with kissing belt device)**

13.1

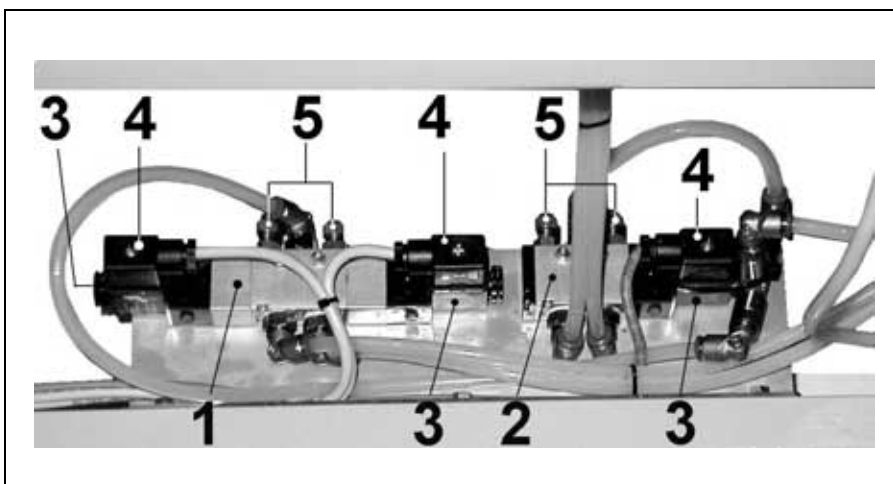



Sealed Air

Shrink Packaging Division

Equipment Center

100 Westford Road

Ayer MA 01432 Telephone: (978) 487-2288